

# UPLIFT DESK<sup>®</sup> CPU Holder CPU128

## Package contents

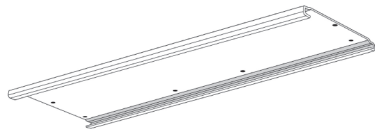

Track



5/8" Wood screws  
(qty 12)



Back bumper

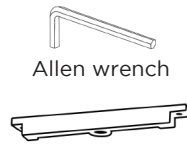

Allen wrench

Track guard

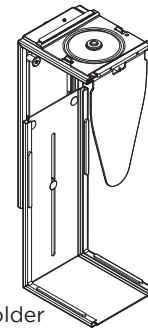

UPLIFT  
CPU Holder

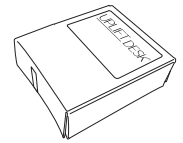

Track Spacer Kit  
(optional)

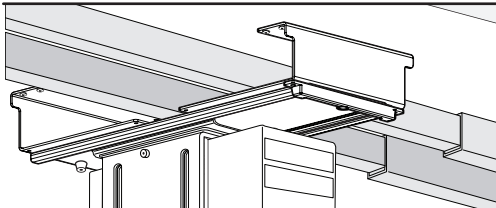

### \*A note before you begin:

Determine where to mount the CPU Holder. If you need to mount it over the Crossbars of your desk, open the box containing the Track Spacer Kit and follow the instructions inside.

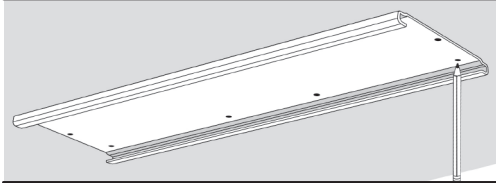

### Step 1

Hold the Track under your desk to see where it will fit. Mark the location of the screw holes with a pencil.



### Step 2

Use a drill with a 1/8" bit and drill your pilot holes where your two pencil marks are located. Drill no deeper than 1/2".

**CAUTION:** Do not drill through the desktop surface.

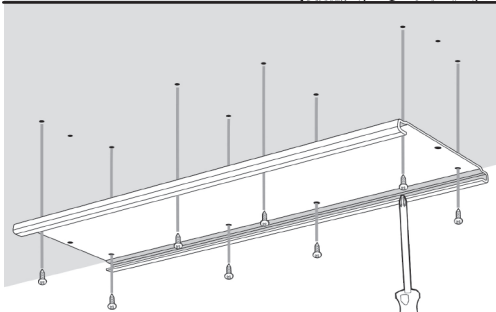

### Step 3

Make sure screws aren't too long for your desktop thickness by holding the screw up to the desktop side. Attach the track to the underside of the desk by using eight (8) Wood screws and a Phillips head screwdriver.

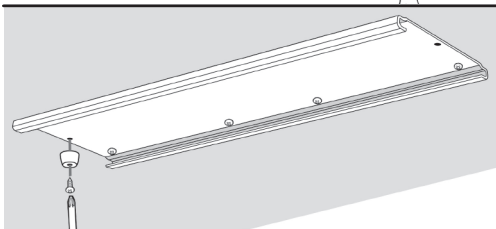

### Step 4

Using one (1) Wood screw, attach the rubber Back bumper to the rear side of the track.

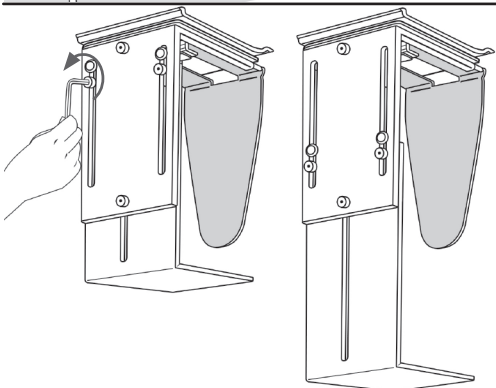

### Step 5

Use the Allen wrench and loosen the three (3) bolts on the side of the CPU holder. This will loosen the lower half of the vertical clamp, and allow you to slide it to its full height.

# UPLIFT DESK<sup>®</sup> CPU Holder

UPL128

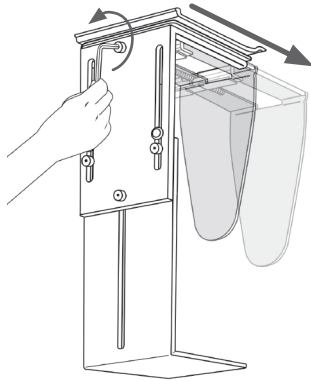

## Step 6

Use the Allen wrench and loosen the one (1) bolt on the side top center of the CPU holder. With sufficient unscrewing, the horizontal clamp will widen.

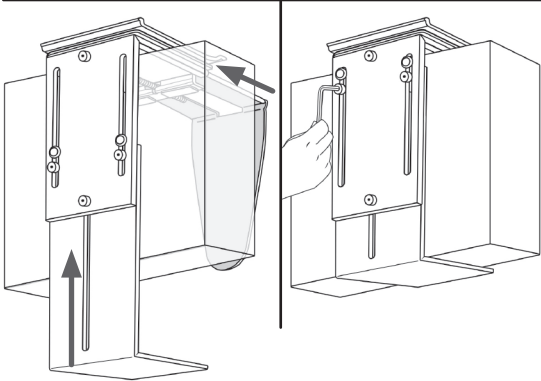

## Step 7

Place your CPU into the holder, and reverse what you did in Steps 5 and 6. Slide the lower half of the vertical clamp up to hold the CPU, and tighten the bolts.

Tighten the top center bolt to bring the horizontal clamp inward and hold the CPU securely.

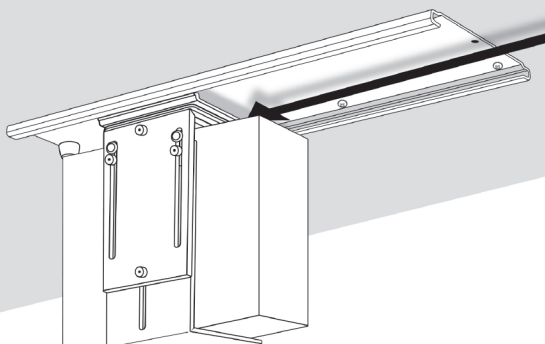

## Step 8

Slide the CPU and CPU Holder onto the track.

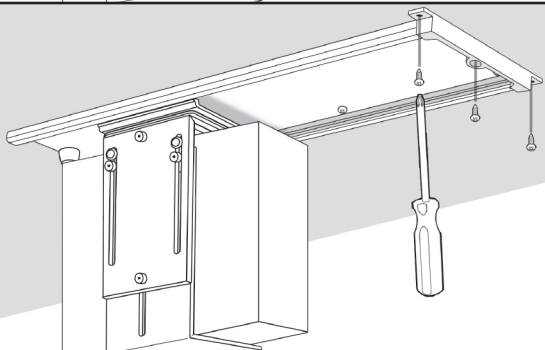

## Step 9

Use (3) three remaining Wood screws to attach the Track guard to prevent the CPU Holder from sliding off.



Read all instructions before installing. Failure to install properly may result in damage or personal injury