

# UPLIFT DESK<sup>®</sup>

E3 Compact Stand Up Desk Converter Instructions  
UDA121

## Package contents

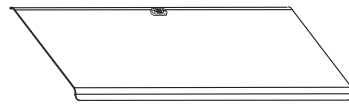

Main unit



Allen wrench  
(4mm)

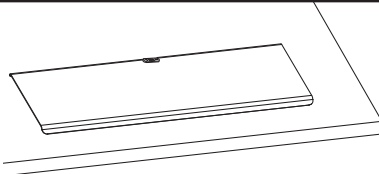

### Step 1

Clear off the surface where you intend to use the unit. Ensure there is at least a 28 inch wide by 14 inch deep space for it.

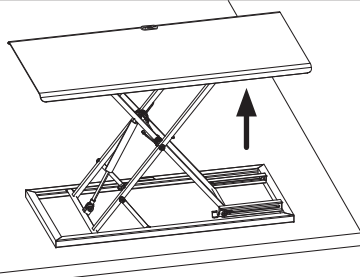
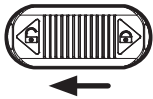

### Step 2

Unlock the riser platform by sliding the tab toward the picture of the padlock that is unlocked. This tab unlocks the unit, and locks it in place when in the lowest position.

Hold surface with both hands and lift.

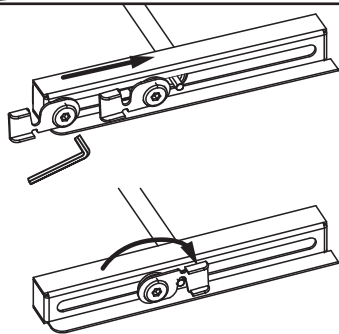

### Step 3

This product is designed to be easily lifted and lowered. To keep it up at a particular height, use the locking hook near the base of the unit.

Lift and move the platform to your desired height. Loosen the lock tab with the included Allen wrench, slide it up to the peg, then flip the lock tab over it. Now re-tighten the lock tab with the Allen wrench. This will keep the platform at your preferred height and create a height-adjustable workspace for you.

You can now place your desktop items such as a laptop or tablet on the main unit's stable worksurface.

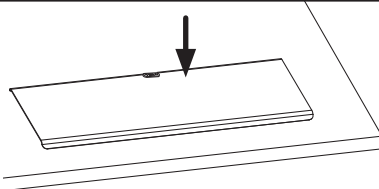
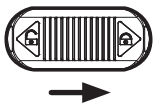

### Step 4

To lower the main unit, flip the locking hook off the peg, grasp each side and with a gentle pressure, lower the converter.

You can lock it in this position to prevent accidental raising of the converter by sliding the tab toward the picture of the padlock that is locked.



# CAUTIONS & WARNINGS



**CAUTION:** Read all instructions before assembly. Failure to assemble properly may result in damage or personal injury.



**CAUTION:** Keep hands clear during operation! Do not reach under the mechanism near the gas cylinder, or other moving parts.



**CAUTION:** The maximum load capacity of the unit is 11 lbs. (5 kgs). Do not overload.



**CAUTION:** Keep devices centered and away from the edge of the worksurface, to prevent them from falling.



**CAUTION:** Make sure that the wires for your devices have enough slack. This will prevent your devices from being pulled off the unit workstation when raising the unit.



**CAUTION:** When moving, remove all devices to avoid harm or damage, and adjust the unit to its lowest position and lock in place with the tab.



**Copyright Notice:** These instructions are a component of the E3 Compact Stand Up Desk Converter Instructions. These instructions are part of the scope of delivery, even if the item is resold. These instructions are also available on the UPLIFT Desk website: [upliftdesk.com](http://upliftdesk.com). Excerpts or copies may not be forwarded to third parties or used in any other published form without the prior written consent of UPLIFT Desk. These instructions are subject to United States copyright law.