

UPLIFT DESK[®]

2-Drawer File Cabinet with Seat, Rolling
STR002

Package Contents

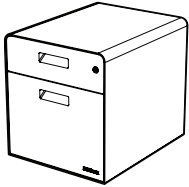

Main Unit



Support caster
(qty 1)



Rear casters
(qty 2)



Front locking casters
(qty 2)



Seat cushion



Adhesive strip



Wrench
(qty 1)



Screws
(qty 16)



Keys
(qty 2)

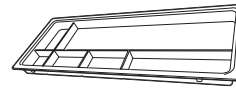

Tray
(optional)



Hanging folder bar
(optional)

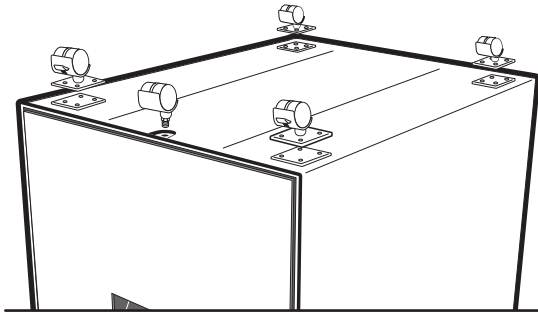

Step 1

After unboxing, grab a friend to help you place the Main unit upside down. Screw the Front locking casters into the holes located at the front, and the Rear casters into the holes at the back. Screw in the Support caster into the hole under the front of the drawer, using the Wrench to tighten it into place. You and your friend can now flip the pedestal over safely. After resting it up-right, test out the Casters by rolling the pedestal around a bit.

To keep your pedestal stationary, simply flip the tabs on the Locking casters into the "down" position.

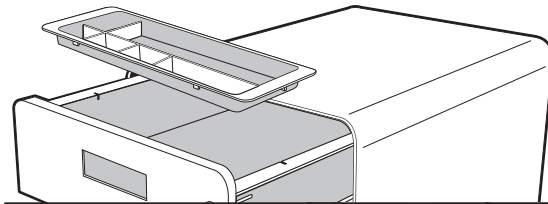

Step 2

Open the top drawer and insert the Tray. There will be small notches on either side of the drawer, that the Tray can slide into. These will keep the Tray in-place in the drawer.

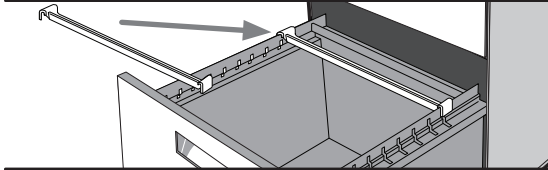

Step 3

Legal size hanging folders will fit lengthwise (from front-to-back) and letter size hanging folders will fit widthwise (from right-to-left). If you want your Letter size folders to hang front-to-back, insert the Hanging folder bar about 12.25" back in the bottom drawer, around where the last slot is located.

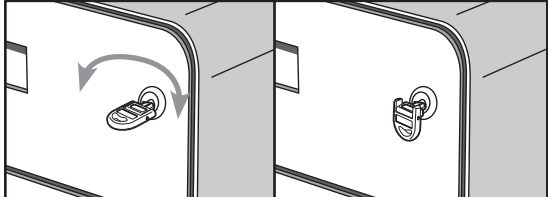

Step 4

To lock the drawers, simply insert the Key and rotate it 180° counterclockwise. To unlock, turn the Key back 180° clockwise.

To avoid losing your Key, you can leave it in the lock; just flip the tab down so it doesn't get snagged on your clothes or personal items.

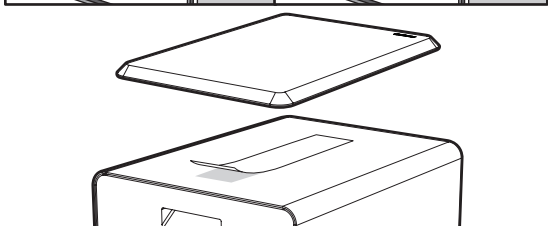

Step 5

Remove the liner from one side of the Adhesive strip and put it on the top of the pedestal. Remove the remaining liner on the Adhesive strip, and place the Seat cushion on top. You can now sit on top of your new pedestal.

The adhesive is not permanent. You can remove the cushion and the strip, and even clean the strip, to allow you to reapply both to your pedestal.



CAUTIONS & WARNINGS

- ⚠ **CAUTION:** Read all instructions before assembly. Failure to assemble properly may result in damage or personal injury.
- ⚠ **WARNING:** While you may sit on the unit, do NOT stand on the unit. Do not stand in or lean on open drawers.
- ⚠ **WARNING:** This product's maximum weight capacity is 225 lbs. EVENLY DISTRIBUTED. Do not exceed the maximum weight capacity.
- ⚠ **CAUTION:** To prevent the unit from tipping over, only have one drawer open at a time.

© Copyright Notice: This guide is a component of the UPLIFT Desk 2-Drawer File Cabinet with Seat, Rolling. This guide is a part of the scope of delivery, even if the item is resold. This guide is also available on the UPLIFT Desk website: upliftdesk.com. Excerpts or copies may not be forwarded to third parties or used in any other published form without the prior written consent of UPLIFT Desk. These instructions are subject to United States copyright law.